

CR360-UTC

Installation

1 Tools & Parts Needed



2 Thread the pedestal's power cable through the fixture. Place the pedestal onto the fixture.



3 Thread the cord reel connector through the pedestal.

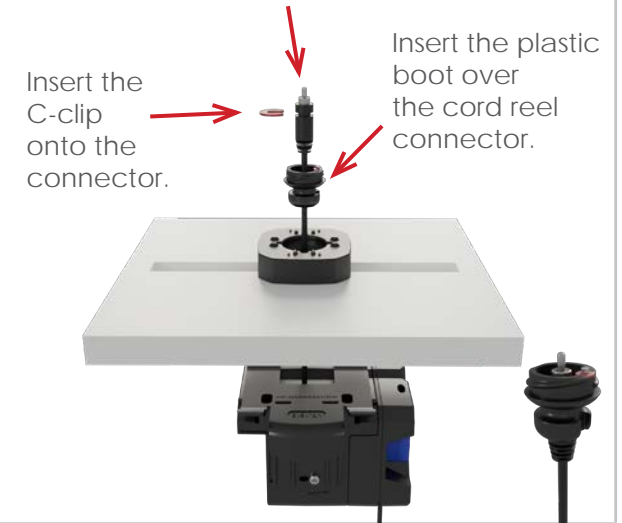

4 Slide the cord reel onto the pedestal mount. Plug the pedestal's power cable into the cord reel.

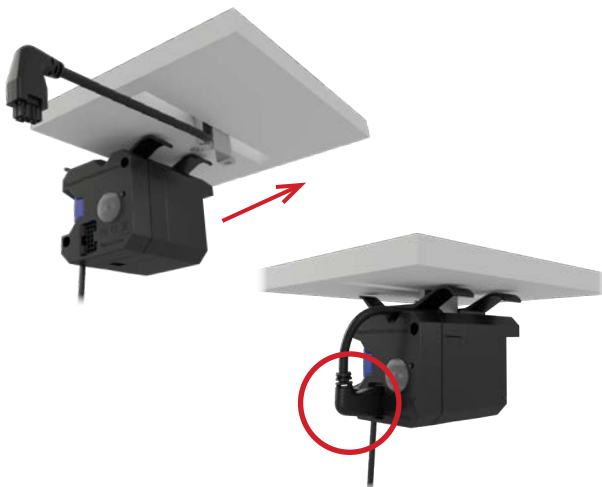

5 Clean the back of the device with an alcohol pad and wipe dry.



6 Plug the power supply into the cord reel and into an AC outlet.

Arm the system by pressing the red "lock" button on the IR Keyfob (KF-1106). Point the key near the side of the pedestal.



CR360-UTC

Sensor Removal

1 Tools & Parts Needed



KF-1106



VP-1446



VP-1477

2



Disarm the system by pressing the green "unlock" button on the IR Keyfob (KF-1106).

3



Use the magnet tool (VP-1446) to twist and release the boot from the sensor.

4



To remove the sensor from the device, place VP-1477 removal tool over the sensor and gently twist to break the adhesive bond.