

ENCORE

Installation

click or scan QR code
for installation video



1 Tools & Parts Needed



2 Remove the cover of the EnCore (VP-1397) with the V-T900 security driver or V-900-T Allen wrench.

Set the security code by changing the DIP switch inside the EnCore.

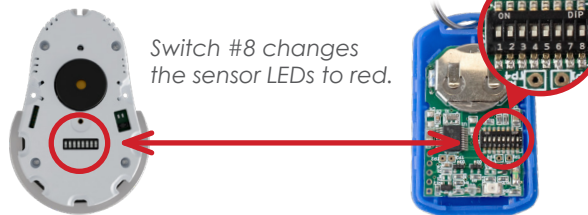

IMPORTANT: The code must match the switches inside the IR Keyfob.

3

Remove the 3M adhesive liner.

Clean the fixture surface. Then, adhere the EnCore to the fixture. Hold in place for 30 seconds.

Plug the appropriate VPG accessory sensors into the EnCore.

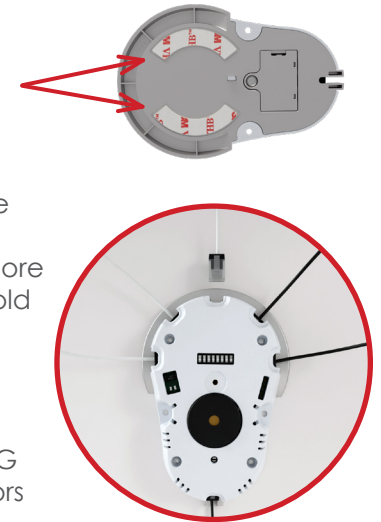

4 Plug the IR Receiver cable into the back port of the EnCore.

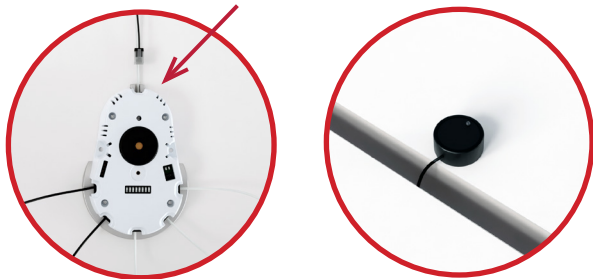

Adhere the IR dome close to the edge of the fixture slot. The IR Receiver will accept the keyfob's IR signal for the EnCore.
Reinstall the EnCore cover.



5



Thread the sensor cables through the fixture. Install the sensors to the products.

6

Plug the V-37 power supply into the EnCore's power connector

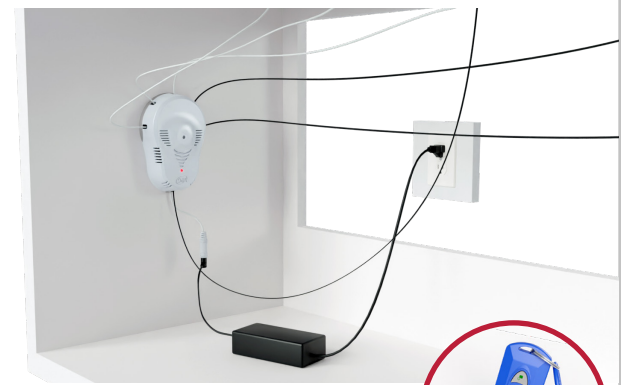

Point the IR Keyfob at the IR Receiver and press the red lock button to arm the EnCore

